



WWW.SIMRACING-PRO.COM



ENGLISH

14B

EDITION



INDEX

| | |
|---|----------|
| 1. GENERAL DATA | 3 |
| 1.1. Preliminary warnings. | 3 |
| 1.2. Address Fabricante | 3 |
| 1.3. Technical Service Management. | 3 |
| 2. DESCRIPTION OF THE PEDALS | 4 |
| 2.1. General description. | 4 |
| 2.2. List of parts supplied. | 4 |
| 2.3. Working principle. | 4 |
| 2.4. Intended use. | 4 |
| 2.5. Foreseeable working conditions. | 5 |
| 2.6. Control panel. | 5 |
| 2.7. Identification and signaling. | 5 |
| 3. WARNINGS AND SAFETY INSTRUCTIONS | 5 |
| 3.1. Protection and safeguards. | 5 |
| 4. STORAGE AND TRANSPORT. | 6 |
| 4.1. Reception of the pedals. | 6 |
| 4.2. Weight and dimensions. | 6 |
| 4.3. Storage. | 6 |
| 4.4. Transportation and maintenance. | 6 |
| 5. LOCATION | 6 |
| 5.1. Unpacking. | 7 |
| 5.3. Site preparation. | 7 |
| 5.3. Assembly. | 7 |
| 5.4. Electrical connection. | 7 |
| 6. CHECKS BEFORE COMMISSIONING. | 8 |
| 6.1. Anchorage. | 8 |
| 6.2. Verification with the connected machine. | 8 |
| 7. INSTRUCTIONS FOR USE. | 8 |

| | |
|---|-----------|
| 7.1. Pre-inspection and adjustments. | 8 |
| 7.2. Uses of controls. | 8 |
| 7.3 Controller Settings. | 9 |
| 7.4 Downloading and Using the Application. | 12 |
| 8. MAINTENANCE | 12 |
| 8.1. General cleaning | 12 |
| 8.2 Replacement of elements | 12 |
| 9. ANNEXES | 13 |
| 9.1. General measurement plan: | 13 |
| 10. DECLARATION OF CONFORMITY | 14 |
| 11. CE MARKING1 | 5 |
| 12. WARRANTY | 15 |
| 13. RECEIPT OF TECHNICAL DOCUMENTATION | 15 |

1. GENERAL DATA

1.1. Preliminary warnings

Be sure to observe the safety and warning notes in this manual when using the pedals.

It is essential to stick to this Pedal Instruction Manual for trouble-free operation and to be able to claim warranty rights.

The handbrake will have to be used for the use for which it has been built. Any other use must be considered dangerous. Any liability of the manufacturer for damages that may be caused by non-compliance with the instructions in the manual is excluded.

This manual contains important information about the operation of the parking brake. For this reason, you should always keep it within the user's reach.

1.2. Manufacturer Address:

Sim Racing Pro 2018 S.L

Tordera Road, 89

17300 Blanes (Girona)

Spain

Phone + 34 627 639 716

info@simracing-pro.com

1.3. Technical Service Management

Sim Racing Pro 2018 S.L

Tordera Road, 89

17300 Blanes (Girona)

Spain

Phone + 34 627 639 716

support@simracing-pro.com

2. DESCRIPTION OF THE HANDBRAKE

2.1. General description

This technical manual contains all the necessary instructions for the installation, commissioning, maintenance and use of the parking brake.

Handbrake parts:

1 Base, 1 piston, 1 lever for drive.

Electrical power supply of the machine:

- Power and power consumption: 5 volts USB-C
- Model: Sim Racing Pro
- Total Power: 225mW
- Total consumption: 45mAh

NOTE: These consumptions are always approximate since they depend on the work performance of each element.

2.2. List of parts supplied.

1. Handbrake assembly
2. 1 unit Allen key n°3
3. 1 unit Allen key n°5
4. 2pcs fixed key 10 mm
5. 1pcs 2m USB cable / USB-C to USB-A
6. 1 user manual / CE certificate
7. 1 Warranty form

2.3. Principle of operation

The SRP-HB handbrake has the following function: **Driving Simulation**

2.4. Intended use

Driving simulation in PC car racing games.

Do not perform different works for which the pedals are designed with elements other than those indicated here.

The manufacturer of the parking brake declines all liability for failure to comply with this warning. Do not exceed the working capacity of the pedals.

2.5. Foreseeable working conditions

The parking brake should be used for people over 6 years old.

The anchoring of the handbrake is essential for its proper functioning.

The correct use of the handbrake and its maintenance implies its longevity.

2.6. Control panel

See point 7.3

2.7. Identification and signalling

Signaling symbols that can be found on the parking brake:

DANGER! Electrical risk



Electrical risk in electrical panel and indicated areas.

Note: The user must ensure the maintenance and conservation of all identification signs and warning plates incorporated in the parking brake.

In no case should they be dismantled or altered.

3. SAFETY WARNINGS AND INSTRUCTIONS

3.1. Protection and safeguards

The materials used in the manufacture of the pedals do not give rise to hygienic risks, although in case of fire the plastic components and lubricants can lead to toxic fumes.

Do not perform any maintenance or cleaning of the pedals or the pavement in their vicinity, without first disconnecting the USB from the PC.

4. STORAGE AND TRANSPORT

4.1. Handbrake reception.

1. Check if the parking brake has suffered any damage during transport.

4.2. Weight and dimensions

| Model | Length, mm. | Width, mm. | Height, mm. | Weight, Kg. |
|--------|-------------|------------|-------------|-------------|
| SRP HB | 210 | 170 | 360 | 2.5 KG |

See plan of general measures 9.1.

4.3. Storage

No special measures are foreseen with regard to their storage. In case the user leaves it unused for a long time, it is recommended to protect it from dust by covering it conveniently and previously disconnecting it from any power source.

4.4. Transport and handling

If the parking brake has to be transported to another location, make sure that the instruction and maintenance manual is with the parking brake so that it can be consulted at the new location. The total weight of it must be taken into account.

5. LOCATION

The handbrake has been designed and built preventing its assembly.

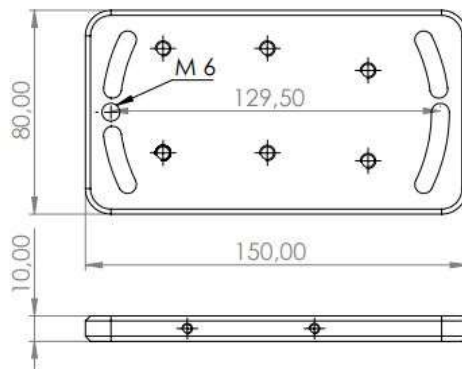

5.1. Unpacking

Once the transport and unloading have been carried out, the handbrake **being** in the vicinity of the place intended for assembly, it will be unpacked with the utmost care and attention.

The parking brake must not be installed if damage that occurred during transit is observed during unpacking. In case of doubt do not use the product and ask the supplier for information.

5.2. Site preparation

The surface area on which the machinery is installed must be provided taking into account the weight of the handbrake indicated in point 4.1 above.

It is recommended on a metal chassis where it can be fixed correctly.

5.3. Assembly

Once the machine has been located and leveled at its workplace, it can be installed and connected.

5.4. Electrical connection

-The electrical connection of the handbrake is 5V via USB. As indicated in the data sheet, or in the plan of general measurements and connections.

- The parking brake requires, for its proper operation, a stable standard supply voltage between the operating ranges of the handbrake. Power defects in **the** handbrake can lead to malfunction and even serious damage or deterioration of the installed electrical components.

Ensure that the electrical cables connecting the handbrake are not left in passage areas, which may hinder other users, and that they are properly protected.

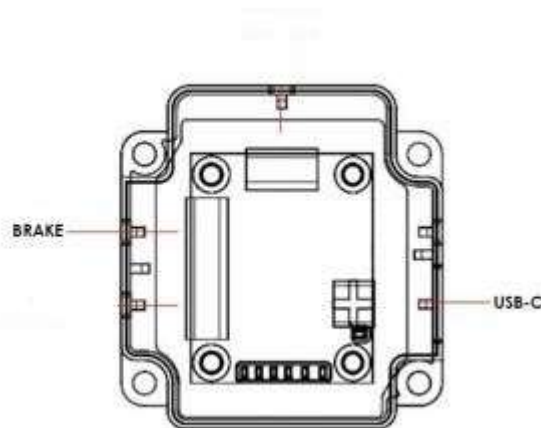

6. CHECKS BEFORE COMMISSIONING.

6.1. Anchorage

Check that the pedals have been levelled correctly, as described in point 5.3.

6.2. Verification with the pedals connected



POWER: Led rojo, indica que la placa tiene alimentación por USB.
WARNING: Led naranja, indica existencia de una avería
INI-OK: Led verde, indica que hay comunicación de datos con el pc.
HANDBRAKE: Led azul, estado del pistón de freno ok.

7. INSTRUCTIONS FOR USE

7.1. Pre-inspection and adjustments

- Before starting the machine, check that the parking brake is connected correctly.
- Check the status of the LED indicators to determine that everything is correct see point 6.2

7.2. Uses of controls

The pedals have a brake actuator lever

7.3 CONTROLLER SETTINGS.

ADJUSTMENT OF THE HEIGHT OF THE MANGO.

There are 9 adjustable height positions pair to the knob, unscrew the 3mm Allen screw to adjust to the desired height. (see attached map)

- 331.55 mm maximum
- 261.55 mm minto

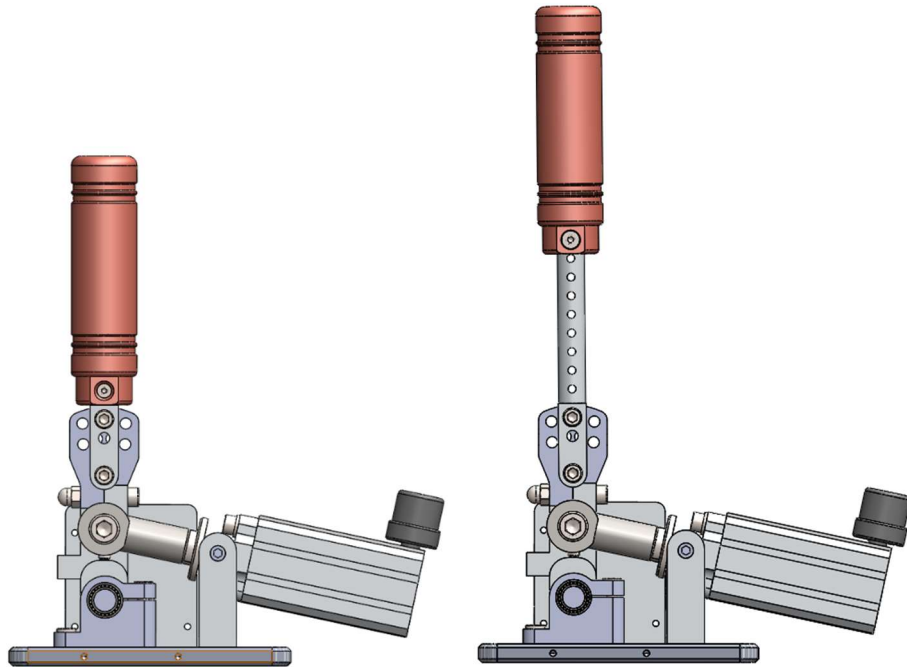

TILT ADJUSTMENT LEVER IN VERTICAL:

There are four inclinations available from 90° to 45°

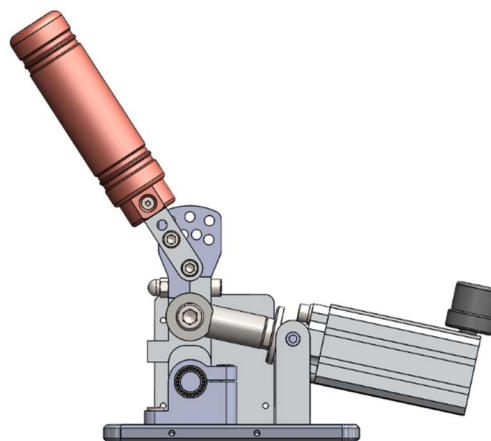
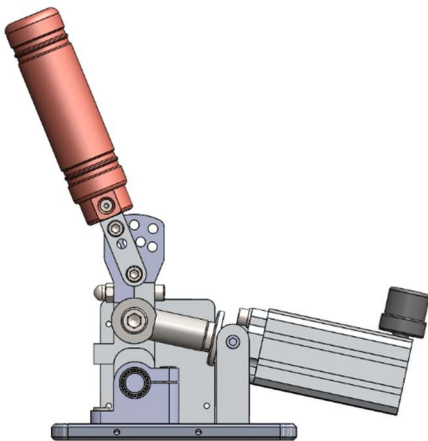
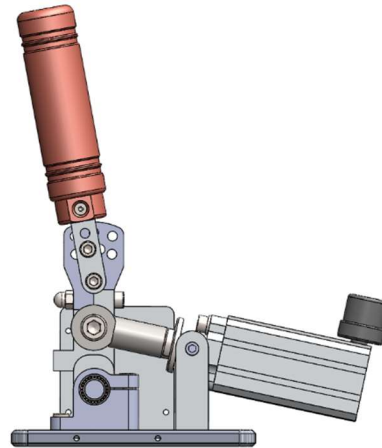
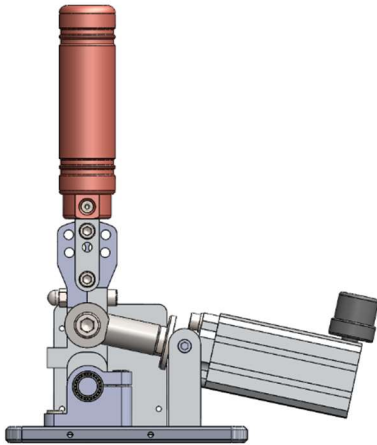

ADJUST TILT LEVER HORIZONTALLY:

There are four inclinations available from 90° to 45°

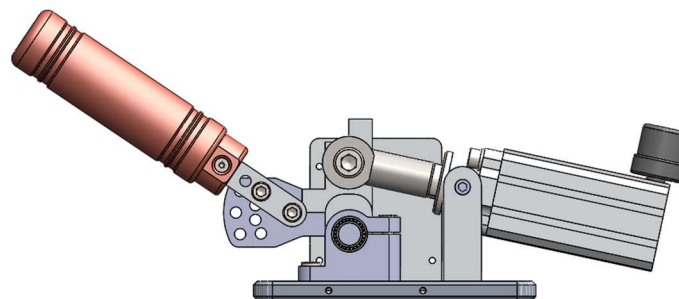
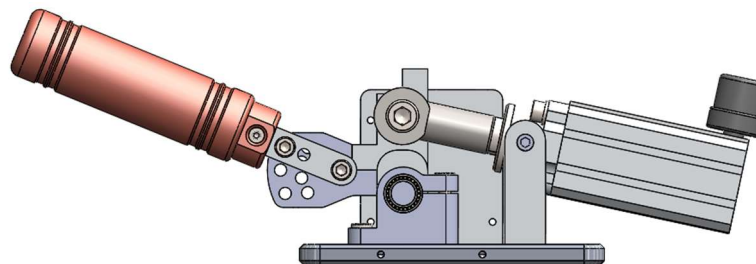
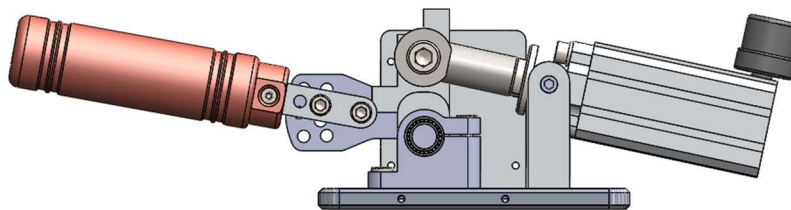
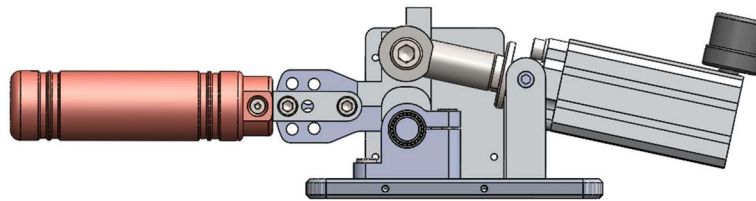

7.4 - Download and use of the application.

Download the application in the download area of the website simracing-pro.com

Run and follow the steps of the application for a good configuration.

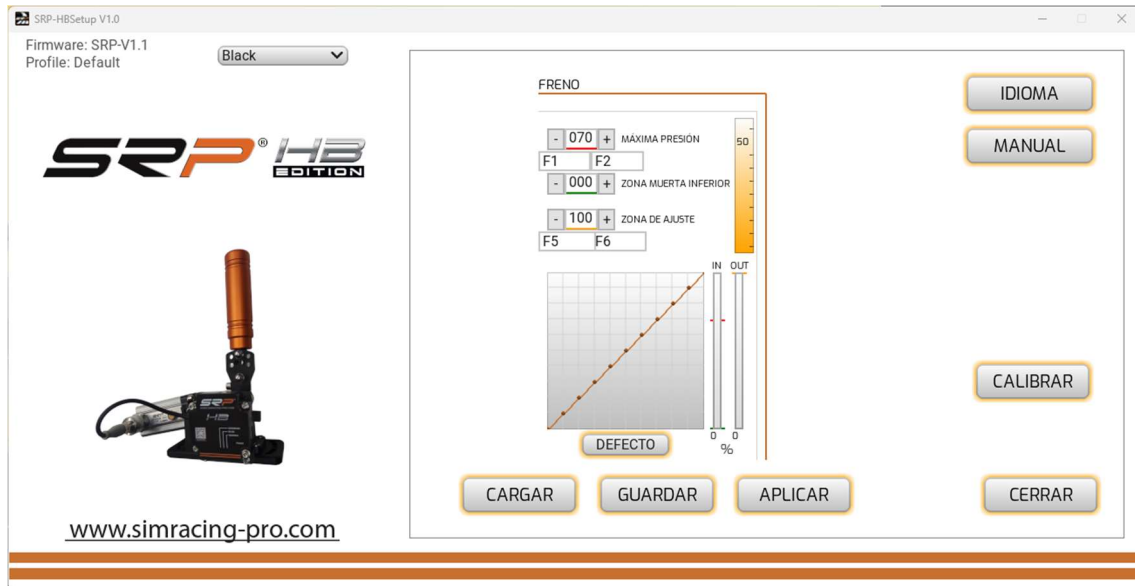

8. MAINTENANCE

8.1. General cleaning

It is advisable to clean the machine from dust periodically. **DO NOT** use cleaning liquids in the area of the plate, as it could cause damage to the machine.

Remember that, by keeping the machine in an optimal state of cleanliness and conservation, its performance will be higher and its useful life longer.

8.2 Replacement of elements

The replacement of any element must be carried out by the Technical Service or by remote connection with the Technical Service

Any maintenance or cleaning operation to be carried out on or in the immediate vicinity of the machinery must be carried out after the power has been disconnected.

9. ANNEXES

9.1. Plan of general measures:

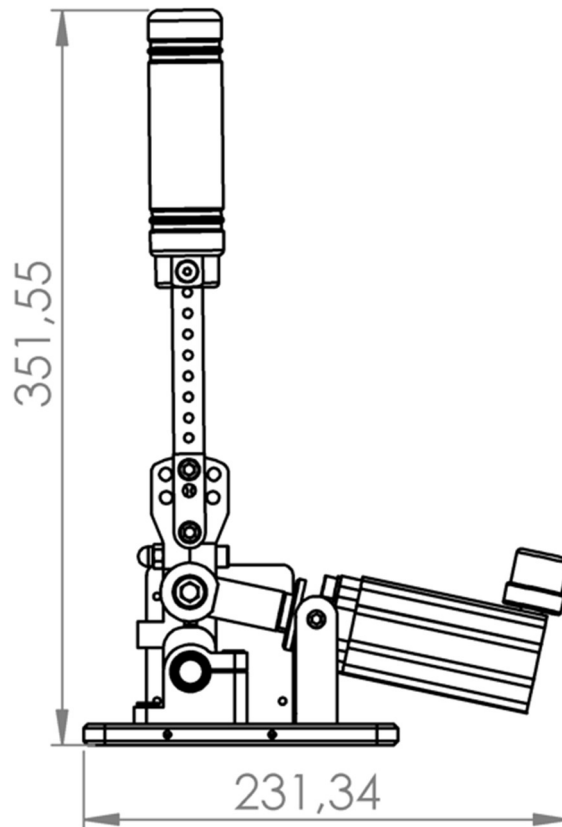
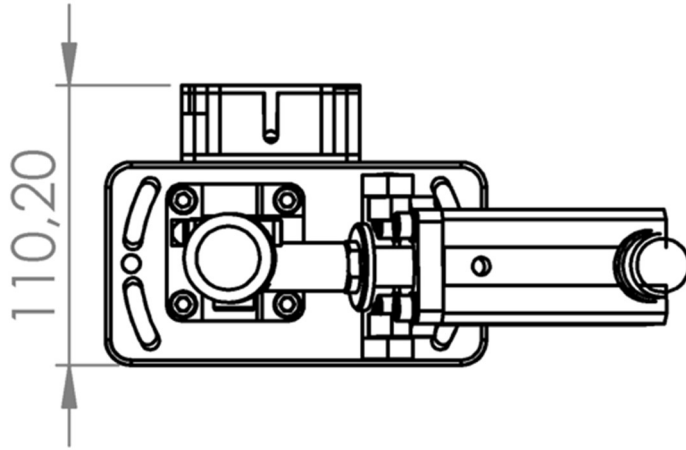

10. DECLARATION OF CONFORMITY

Declaración de conformidad

Empresa: **Sim Racing-Pro S.L.**
Carretera de Tordera nº 89
17300 BLANES (Girona)

Producto: **Freno de mano de Simulación**
Modelo:
N.º Serie:
Año de fabricación:

En conformidad con la siguiente normativa:

2006/42/CE Directiva de Maquinas

2006/42/CE Directiva relativa a las máquinas.

2006/95/CE Directiva de baja tensión.

2004/108/CE Directiva de compatibilidad electromagnética.

Declaramos que la máquina indicada cumple con los requisitos esenciales de seguridad y salud de la Directiva de máquinas de la Comunidad Europea

Esta Declaración de Conformidad perderá toda su validez, en caso de una modificación de la máquina no acordada o no autorizada por cualquier persona no perteneciente al Servicio Técnico de Sim Racing- Pro S.L

Blanes, 1 de septiembre de 2.023

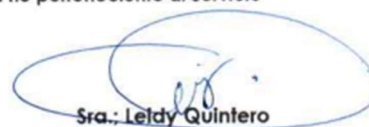

Sra.: Leidy Quintero

**REPRESENTANTE LEGAL
SM RACING-PRO S.L**

11. "CE" MARKING

The plate bears the manufacturer's mark, the CE marking of conformity and the manufacturer's social data. At the top of the plate the specific data of the handbrake **are specified**: brand, model, the number of the series and year of manufacture. In the last box the essential technical data of the pedals are specified: the voltage

12. WARRANTY

The company SIM RACING PRO 2018, SL, undertakes to guarantee the correct functioning of the handbrake and the replacement of the elements that compose it due to a manufacturing defect.

This guarantee will be effective provided that the normal operation of the pedals has not been distorted or varied and when the damaged element HAS NOT BEEN MISTREATED OR MANIPULATED.

Warranty: 2 years from invoice date, except electrical components and parts of usual wear.

13. RECEIPT OF TECHNICAL DOCUMENTATION

List of documentation delivered:

Paper support x

- Instruction manual
- EC Declaration of Conformity (included in the manual)
- Warranty sheet (included in the manual)